

Thank you for purchasing A/F meter, before operating the unit, please read these instructions thoroughly and retain them for future reference.

**Notice**

- The LCD meter is made for DC 12V.
- PS.** The oxygen sensor will start to detect the signal after starting the engine over one minute.
- When installing the meter, please use the attached signal wire to avoid the electromagnetic wave interference caused by the wire.
- For installation, please follow the steps described in manual. Any damage caused by wrong installation shall be imputed to the users.
- To avoid a short circuit, please don't pull the wire when installing, don't break or modify the wire terminal.
- Do not disassemble or change any parts in the manual description.
- The interior examination or maintenance should be executed by our professionals.
- This unit is for Tuning purposes only.**

**SYMBOL NOTE:**

- NOTE** You could get the installation details from the information behind the mark.
- NOTE** Some processes must be followed to avoid the damage caused by wrong installation.
- WARNING!** Some processes must be followed to avoid damages to yourself or the public.
- CAUTION!** Some processes must be followed to avoid damage to the vehicle.

**1-1 Accessories**

<b>1</b> Meter X 1 	<b>2</b> Signal connect wire X 1 	<b>3</b> Oxygen sensor X 1 	<b>4</b> Sensor bung X 1 
<b>5</b> Bung cap X 1 	<b>6</b> Meter bracket X 1 	<b>7</b> Rubber gasket X 1 	<b>8</b> Rubber gasket X 1 
<b>9</b> Steel gasket X 1 	<b>10</b> M5X1.8L Hexhead screw X 2 	<b>11</b> M5 washer X 2 	<b>12</b> M5 spring washer X 2 
<b>13</b> Connect terminal X 1 	<b>14</b> M3 wrench X 1 	<b>15</b> M4 wrench X 1 	

**NOTE** Please contact the local distributor if the items you open are not the same, with the above-listed one.

**1-2 Option accessory**

**1** Sensor adapter X1  
(For 2 strokes engine only!)

**NOTE** Some option accessories are not sold in some area. Please check with your dealer for more information.

**2-1 Wiring installation instructions**

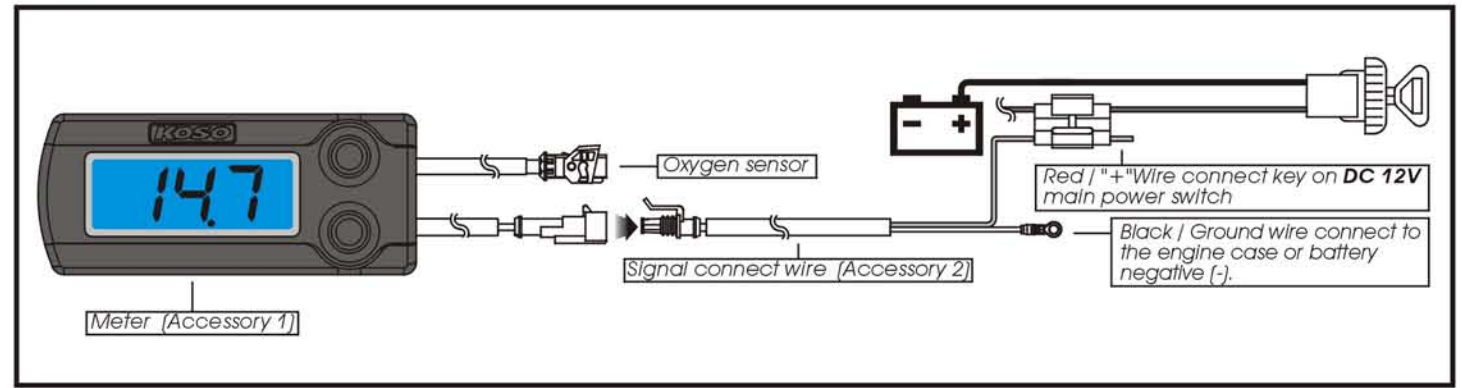

**2-2 Oxygen sensor installation**

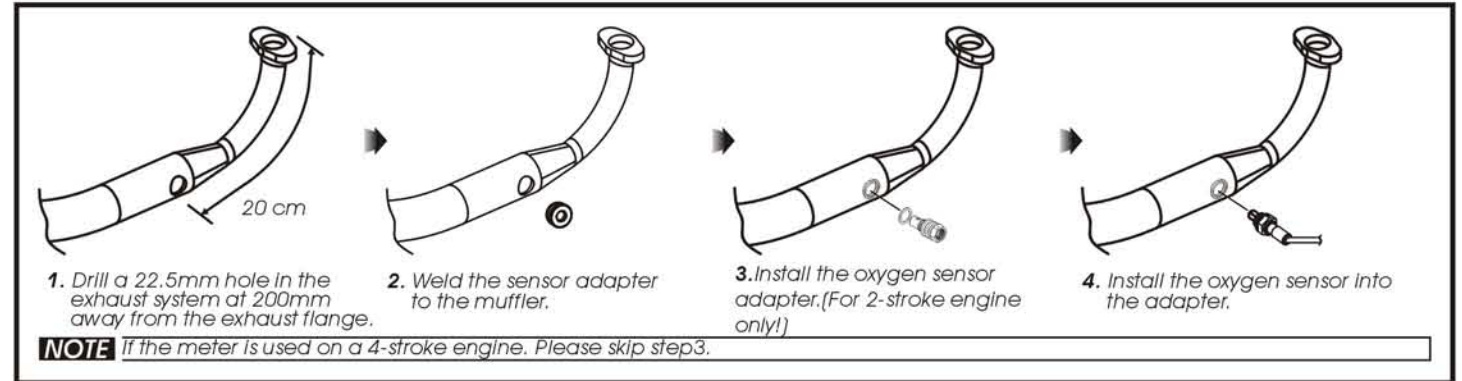

**3-1 Instruction of function**

○ Display range	10.0~24.0
○ Over lean setting	14.8~24.0
○ Over rich setting	14.6~10.0
○ A/F ratio display range	<0.5 second
● Back light	DC 12V
● Effective temperature range	-10~+60°C
● Water proof	JIS D 0203
● Meter size	W99.6 X L42 X H22.5mm
● Meter weight	+/- 85g

**NOTE** Design and specifications are subject to change without notice!

**4-1 Function and setting**

"R" (RICH) means the air/fuel ratio is too rich to detect. "L" (LEAN) means the air/fuel ratio is too lean to detect.

Over lean warning. Over rich warning.

**NOTE** The backlight is lighting in blue now. The backlight is lighting in blue now. The = symbol showing on screen, backlight is flashing by blue/red color now. The = symbol showing on screen, backlight is flashing by blue/red color now.

## 5-1 The over lean warning setting.



On main screen, press down **SELECT & ADJUST** 3 seconds to enter the setting screen.



Press **ADJUST** button to enter the over lean setting screen. Press **ADJUST** button to turn on or turn off the function.

⚠ The symbol is flashing now.

⚠ If you choose **OFF** the lean warning function will close. Press select button to enter into airfuel rich setting screen



Press **SELECT** to enter the over lean setting screen.

⚠ The symbol is flashing now.



press **ADJUST** button to input the number you would like to set.

⚠ The digit can be set if flashing now.



press **SELECT** button to enter next digit.



Press **ADJUST** button to input the number you would like to set.



press **SELECT** button to enter next digit.



Press **ADJUST** button to input the number you would like to set.

⚠ The digit can be set if flashing now.

⚠ The digit can be set if flashing now.

⚠ The digit can be set if flashing now.

⚠ The digit can be set if flashing now.



Press **SELECT** button to enter the over rich warning screen. For example : the lean warning setting was modified from 18.5 to 22.4 now.



The over rich warning setting screen.

⚠ The symbol is flashing now.

⚠ The digit can be set if flashing now.

## 5-2 The over Ratio rich warning setting.



Press **ADJUST** button to enter the over lean setting screen. Press **ADJUST** button to turn on or turn off the function.



Press **SELECT** button to enter rich setting screen.



Press **ADJUST** button to input the number you would like to set.



Press **SELECT** button to enter next digit.

⚠ The symbol is flashing now.

⚠ The digit can be set if flashing now.

⚠ The digit can be set if flashing now.

⚠ The digit can be set if flashing now.

⚠ If you choose **OFF** the rich warning function will close. Press select button to return to main screen.



Press **ADJUST** button to input the number you would like to set.



Press **SELECT** once to return to main screen. Now the over rich warning setting is 13.8.



Back to main screen.

⚠ The digit can be set if flashing now.

⚠ The digit can be set if flashing now.

## 6-1 Troubleshooting

⚠ **CAUTION!** Please install oxygen sensor as shown in Installation 2.2, wrong installation will cause airfuel ration number display abnormal.



1. Oxygen sensor is not connected or the connection is bad.  
2. oxygen sensor heater has failed.

### Solution

1. Check the connection of the oxygen sensor if the warning message keeps showing. Please change to a new oxygen sensor.  
2. press any button to restart the Oxygen sensor after check.

⚠ The back light showing blue the showing flash now.

**NOTE** Press any button to restart the oxygen sensor after check



1. Oxygen sensor has failed.  
2. Battery voltage is too low

### Solution

1. Check the connection of the oxygen sensor. If the warning message keeps showing. Please change to a new oxygen sensor  
2. Check the battery voltage.

⚠ The back light is showing red now

**NOTE** Press any button to restart the oxygen sensor after check



1. Oxygen sensor has failed.

### Solution

1. Check the connection of oxygen sensor. If the warning message keeps showing. Please change to a new oxygen sensor.

⚠ The back light is showing red now

**NOTE** Press any button to restart the oxygen sensor after check



1. Oxygen sensor has failed.

### Solution

1. Check the connection of oxygen sensor. If the warning message keeps showing. Please change to a new oxygen sensor.

⚠ The back light is showing red now

**NOTE** Press any button to restart the oxygen sensor after check